

# Terminal block 3 poles 46.413.1139.50

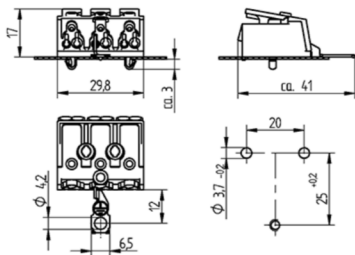

T 85  
-40°C



max.  $\varnothing$  1,8 mm



max.  $\varnothing$  1,8 mm



0,5 - 1,0

16 A  
450 V



# Terminal block 3 poles

## 46.413.1139.50

---



### DESCRIPTION

Internal wiring: only for solid conductors and 7 stranded wire ends

Cable diameters:

External: 2 x 0.5 - 2.5 mm<sup>2</sup>

Internal:

- a) 1 x 0,5 - 1,0 mm<sup>2</sup>, releasable

- b) 1 x 0.5 - 2,5 mm<sup>2</sup>, releasable

- c) Suppression capacitor: 1 x 0.5 - 0.75 mm<sup>2</sup>, not releasable

Product name:	Terminal block 3 poles
Mounting method 1:	Push through mount
Material:	Housing: PC
Marking:	+D1 ? -D2
Material thickness:	0.5 - 1.0
Contact opening:	With integral cable release
Quantity of poles:	3
Pkg.:	500